

# Don Pasquale

An opera buffa in three acts by Gaetano Donizetti

Libretto by Gaetano Donizetti and Giovanni Ruffini, after Angelo Anelli's libretto for Pavesi's Ser Marcantonio

First performed: Tour 2011



Bill Cooper

## CREATIVE TEAM

Director ..... Mariame Clément

Designer ..... Julia Hansen

Lighting Designer ..... Bernd Purkrabek

## CHORUS BREAKDOWN

9 Tenors  
9 Basses  
9 Sopranos  
9 Mezzos  
1 Actor (female)

## TECHNICAL PERSONNEL

10 Stage Crew  
1 Flymen  
6 Stage Managers  
2 Lighting Crew + 1 Board Operator  
0 Follow Spots  
7 Running Wigs  
5 Make-Up  
2 Running Wardrobe  
8 Dressers

## SPECIAL EFFECTS

Bubble machine (for bath)

## TRANSPORT

2 High Cube Containers or  
2 Megacube Trailers (approximately)



Mike Hoban



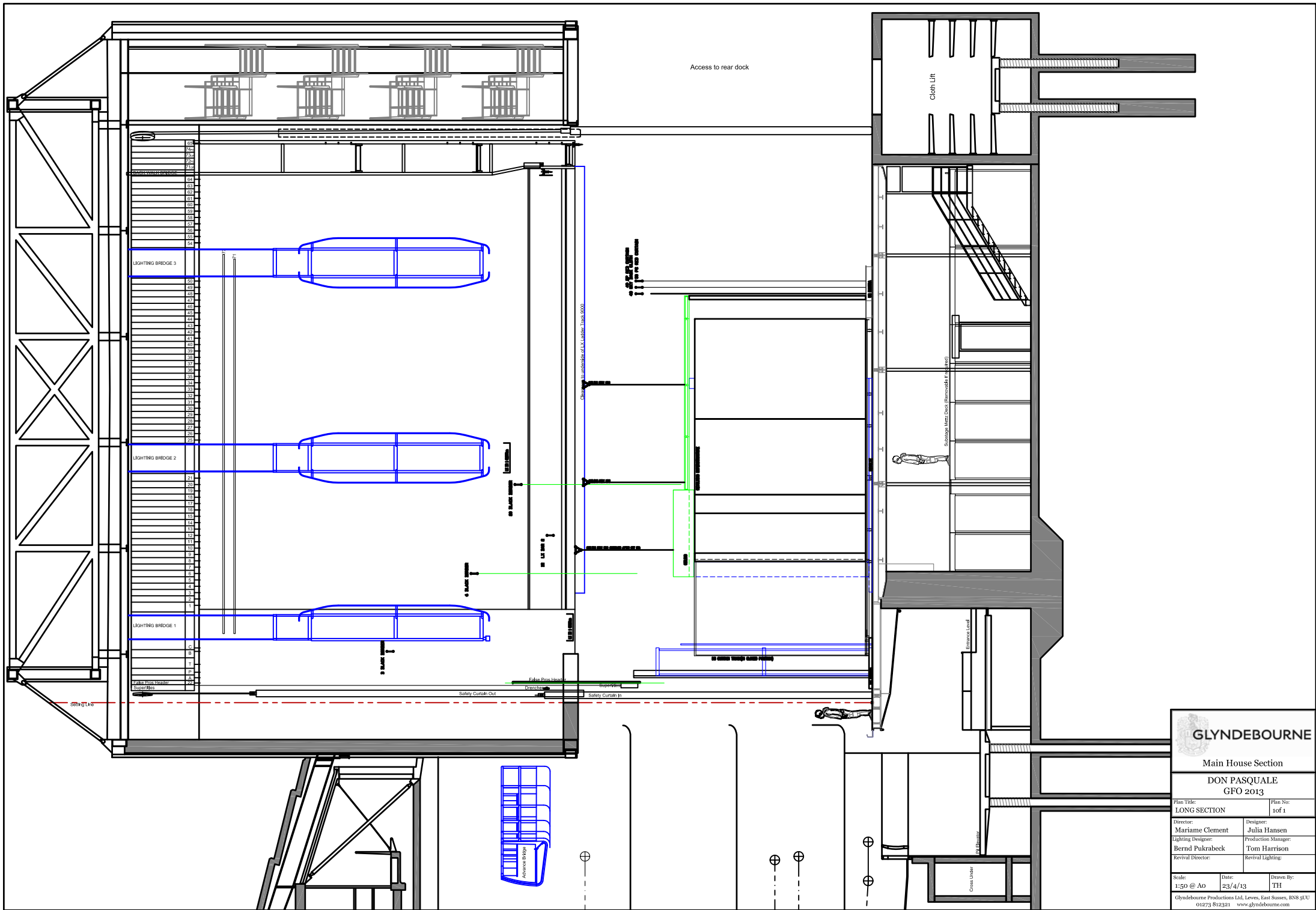

**GLYNDEBOURNE**

Main House Section  
 DON PASQUALE  
 GFO 2013

Plan Title: <b>LONG SECTION</b>	Plan No: 1 of 1	
Director: <b>Mariame Clement</b>	Designer: <b>Julia Hansen</b>	
Lighting Designer: <b>Bernd Pukrabeck</b>	Production Manager: <b>Tom Harrison</b>	
Revival Director:	Revival Lighting:	
Scale: 1:50 @ A0	Date: 23/4/13	Drawn By: TH

Glyndebourne Productions Ltd, Lewes, East Sussex, BN8 9LU  
 01273 812321 www.glyndebourne.com